

The square footages and room size information are deemed to be reliable but are not guaranteed and should be independently verified. This drawing is for marketing purposes only.

Pool & Spa Area

# 61 E Morning Ridge Pl

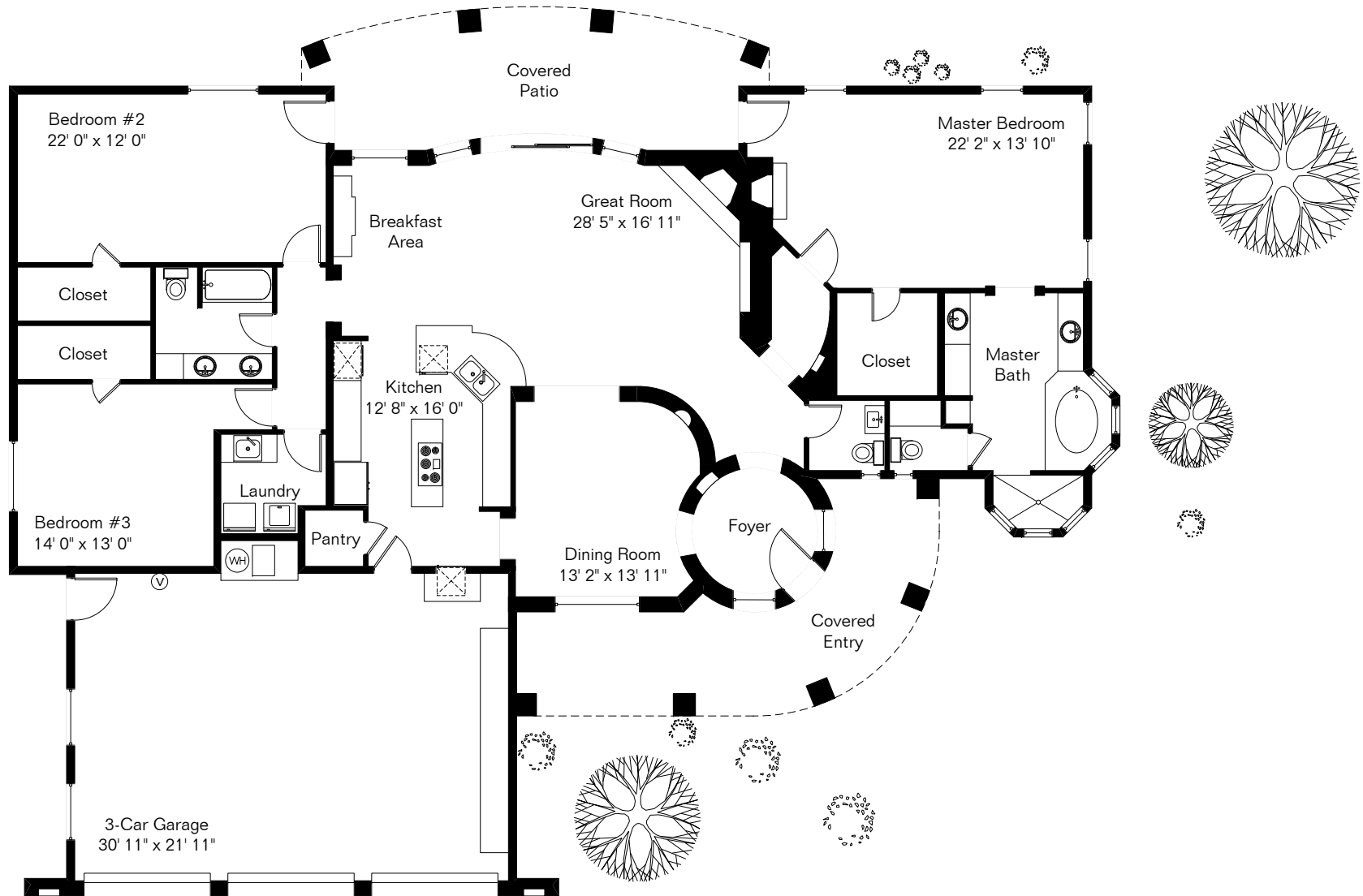

Site Visit January 2020

0 ft. 6 ft. 10 ft. 20 ft.



Copyright 2020 Floor Plans First! LLC  
All Rights Reserved.

Living Area 2,517 Sq Ft  
Garage 749 Sq Ft

[www.FloorPlansFirst.com](http://www.FloorPlansFirst.com)

Toll Free (877) 887-1500  
Voice (520) 881-1500

Floor Plans First!  
See the Floor Plan First!